



PRE ENGINEERING BUILDING & COMPONENTS

www.ritutech.net

STRUCTURAL SYSTEMS
RANGING FROM
MULTI-STOREY
BUILDING TO
VAST CLEAR SPAN
BUILDINGS





About Us

Leader In Pre-Engineered Buildings & Heavy Steel Structures

Ritutech is counted as one of the reputed leader amongst the prestigious clan of PEB manufacturers. Established in the year 2010 at Haridwar (Uttarakhand), Ritutech has emerged as 3rd largest manufacturing facility of PEB in northern India with total plant area exceeding 3,00,000 SQFT and total annual production capacity 72,000 MT spread over three units. Third unit established at Agra (Uttar Pradesh) in the year 2023. Since its establishment, and now with scaled-up capacity, Ritutech can now offer to meet very large requirements with assured quality and vast varieties.

Ritutech Pre-Engineered Buildings offer best-in-class product quality and workmanship. This is ensured by a stringent quality assurance system followed by our dedicated & vigilant QC team. With a strength of 450+ employees Ritutech is steadily focused towards meeting the diverse expectations of clients with uncompromised quality. We are an ISO 14001:2015 certified company which offers cluster of solutions with quality assurance in terms of wide range of products required for Pre-Engineered buildings & Heavy steel structures etc.

Our design & engineering team works on latest design and detailing softwares as per industry standards. Having executed more than 1500nos PEBs throughout the country in diverse industries and applications, our experts have vast domain knowledge for delivering best value to our esteemed clients.

Our project sites are professionally managed for delivering good workmanship, and ensuring timely handover, with due emphasis on the EHS requirements at site.

Ritutech is one stop solution for variety of products, ranging from PEB structures, Color Coated Metal Roofing Sheets, Turbo Ventilators, Ridge Ventilators, and various other products. The entire assortment is exceptionally designed and developed by our experienced engineers and qualified professionals using superior quality grade raw materials. Our product and quality service deliverance result in sturdy construction with dimensional accuracy, easy installation, and low maintenance with excellent performance. The entire process is supervised effectively by our team of experts, right from the procurement of raw materials till the finished product is dispatched. These products are tested by our Quality Control team on set parameters as per industry standards.



Products

We provide complete component packages for Pre – Engineered buildings such as roof and wall cladding, composite roofs and wall panels, structural decks, purlins and spacer systems roof lights, gutters and flashing of all types, fixings for every variety of roof and wall applications. Our products are of the highest standards and no shortcuts are made in delivering and meeting our valued customer satisfaction. The manufacturing plant is based in Haridwar, Uttarakhand. The dedicated and readily accessible management & workforce is acknowledged within the industry for its expertise.

Our Products

1. Pre-engineered buildings
2. Heavy steel structures
3. Metal roofing and cladding sheets
4. Prefabricated steel structures, crane structures, crane beams, canopies space frames
5. Ridge Ventilators (which suits to all types of sheeting profiles).
6. C-purlins & Z-purlins
7. Skylights, Wall light (poly-carbonate & FRP sheets)
8. Metal decking sheets
9. Insulated puff-panels
10. Light gauge frame structure(L.G.F.S)
11. Porta cabins

Pre Engineered Building & Components

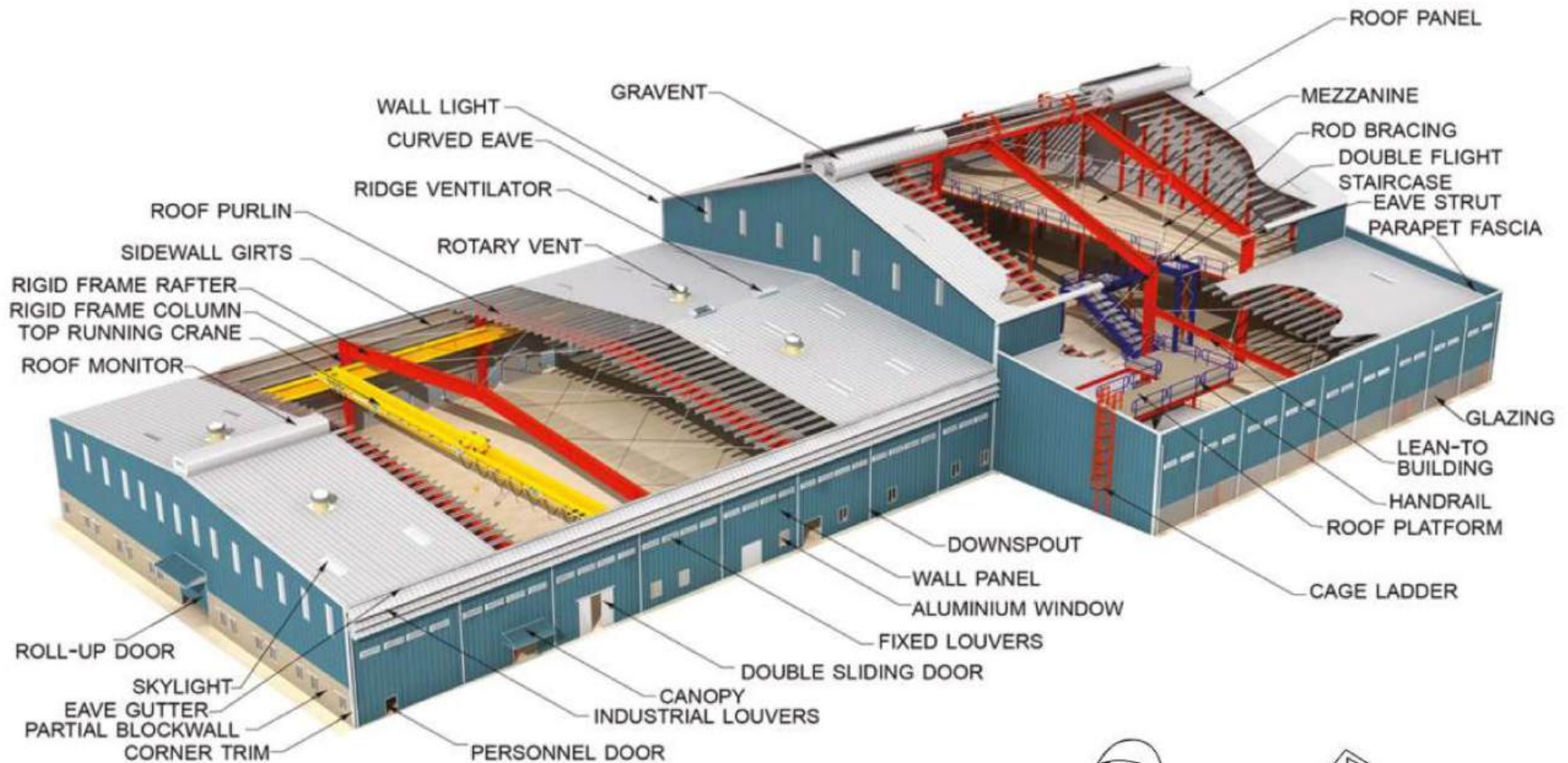

Purlins & Sky-light

Purlins, Girts & Eave Struts

Introducing a comprehensive package range of Z&C Purlins. These purlins are widely useful in various construction industries and buildings. These are offered in different specifications to fulfill the needs of the Clients Like.

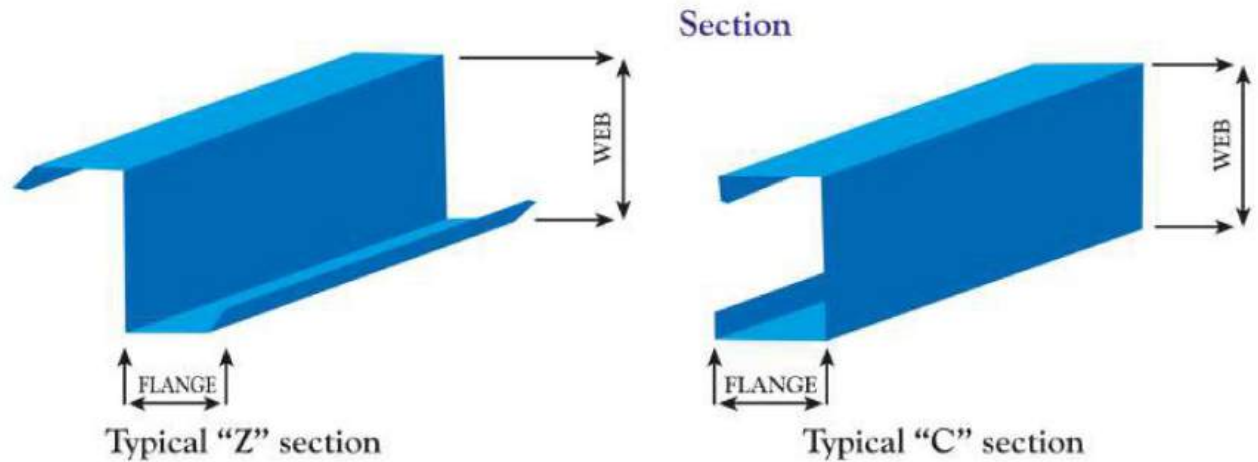

Skylight / Wall Lights / Polycarbonate Sheet



Features

- High resistance to weather : High resistant anti UV material
- Easy to install : 0.5 times heavy as normal glass, and can be installed in curve forms
- Reduce high installation cost
- High Transparency : Transparency (Over 85%) similar to that of normal glass
- Resistant to acidic forms
- Scattered light due to embossment

Usage

- Transparency from roof & walls
- Reduces requirement of windows for light
- Light can be reached in centre of building of big spans Corridors & Arcades

Roofing Sheet

Galvalume Roofing Sheets :

We are the manufacturer of Roofing Sheets that can be availed in various colors, sizes, length, thickness and coatings as per the requirements. Roofing Sheets offer protection and aesthetics at lower costs due to reliable performance, these sheets are highly in demand

Features :

- Attractive look
- Can be fabricated and crawled with immense ease
- Excellent Insulation
- No cold bridging
- No wear & tear off
- Anti-corrosion
- Easy to install
- Low heat conductivity
- Very good aesthetes

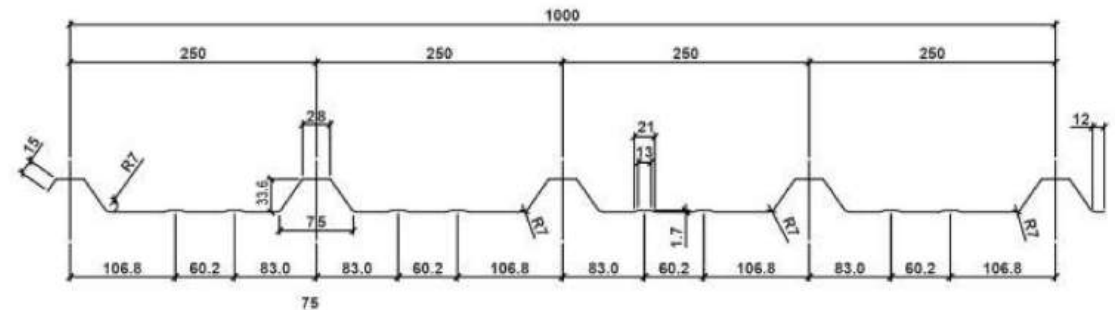

Wall Sheet

Colour Coated Profile Sheets :

We are instrumental in providing clients with quality assured range of Color Coated Wall Sheet. As per the varied requirements of our esteemed clients, we provide those sheets in various colours and sizes. The offered range is sourced from trustworthy and certified vendors of the market.

Features:

- With minimum thickness almost double strength of sheeting as compared with conventional sheets
- Extremely weatherproof and hence does not allow damages caused by sun rays and wind
- Colors used are non-toxic and environment friendly
- Availability in various colors and can be fitted quickly and simply
- Available at reasonable cost

Ventilators



Turbo Ventilators

A wide range of Turbo Ventilators. These ventilators are fabricated from good quality stainless steel and Aluminum raw materials. Further, it provides safe, cool and healthier environment by removing the entrapped heat, smoke and emission. These ventilators are available in various specifications of dia, base and colors.

Features :

- All Aluminium, anti-corrosive construction, stainless steel shaft
- Double shielded ball bearing
- Tested for gusty & strength
- No electrical power required
- Totally maintenance free
- Fit & forget
- Reduces heat & removes smoke etc
- Create healthy atmosphere



Ridge Ventilators

We are engaged in manufacturing, supplying and exporting an excellent range of Ridge Ventilators. Manufactured using PPGL, PPGI & Bare Galvalume material, our offered range is in compliance with set industry standards. Available in varied design at affordable rates, these ventilators are in huge demand.

Features :

- Does not require energy source like electricity, generator, UPS and battery backup
- Based on the free-floating concept
- As there is no moving part so works for very long time.

Insulations

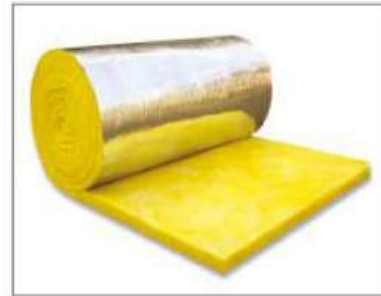

Glass Wool Insulations

Ritu Tech provide roofing insulation material including Glass Wool with foil in various thickness and density to get the thermal insulation. The fiber glass wool range offered by us are developed by using fine quality tested glass fibers.



Bubble Wrap Insulations

Polynum insulation sheets are consist of two layers of polyethylene air bubble film laminated with pure aluminum foil. The material provides excellent insulation: reflects up to 97% of radiant energy in addition to resist other types of heat transfer from conduction, convection & heat radiation.

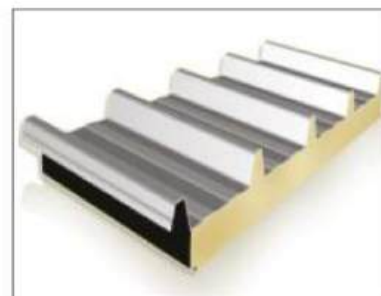

Roof & Wall Puff Panels

Owing to the immense experience and a competent team of experts, we are able to offer Roof & Wall puff panel. Those puff panels suits for requirements of pharma and cold storage and other controlled temperature applications

Features :

- High thermal insulation strength
- Toughness
- Durability
- Can be available in various thickness and densities
- Fungus and pest resistant

Structural Accessories

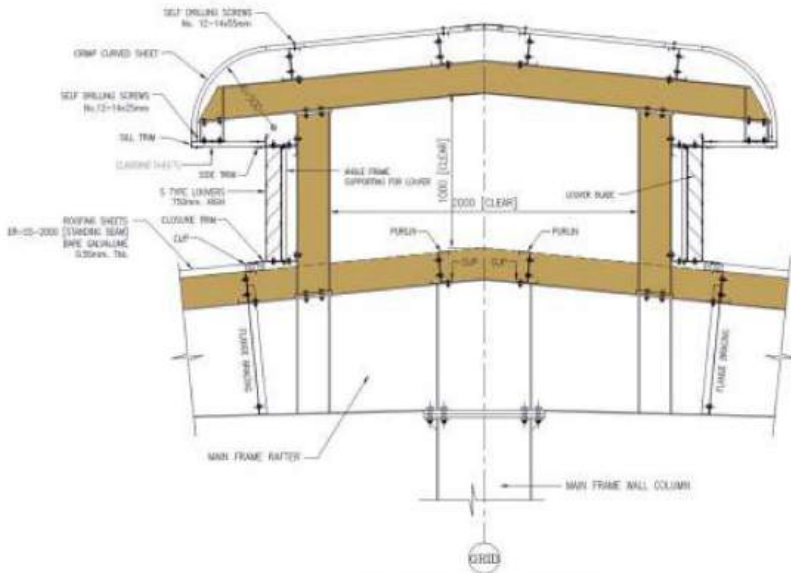

Roof Monitor

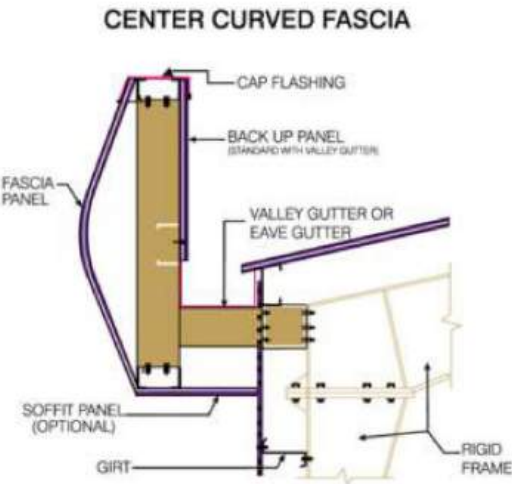

Fascia

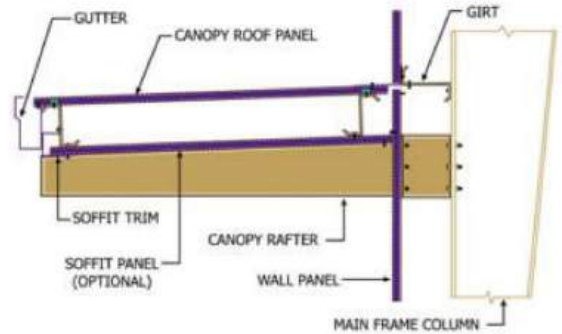

Canopies



Sliding Door



Cage Ladder



Fixed Louvers

Main Frames

We provide optimum size primary framing to give the building economy as well as the stability. Columns are being introduced as per requirement for increasing building width. Some of the frames are as given below.

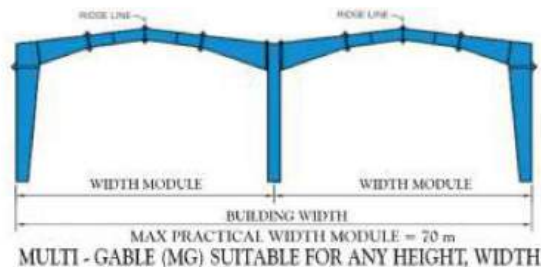
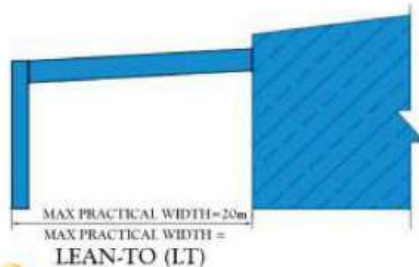
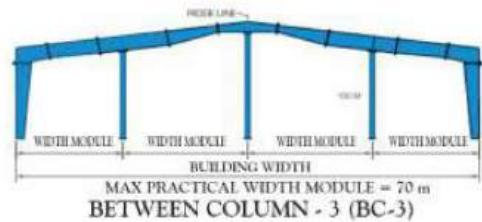
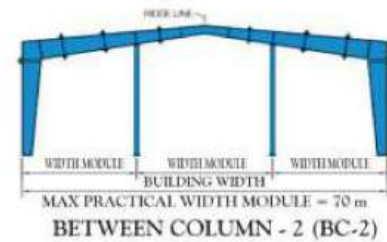
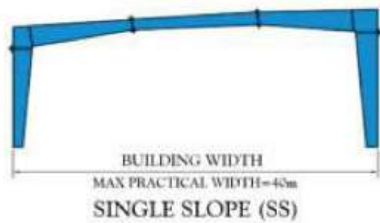
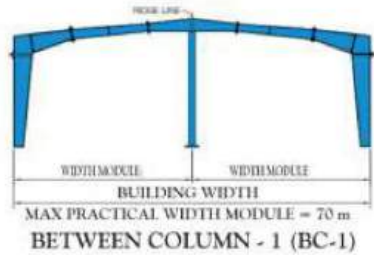
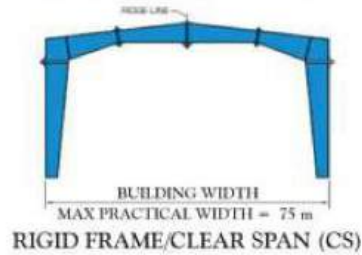

Crane System

When a crane system is required in a Ritutech structural steel buildings, we normally supply column or rafter brackets and the crane runway beam that support the crane system. We design the crane system after understanding the complete requirements of the customer.

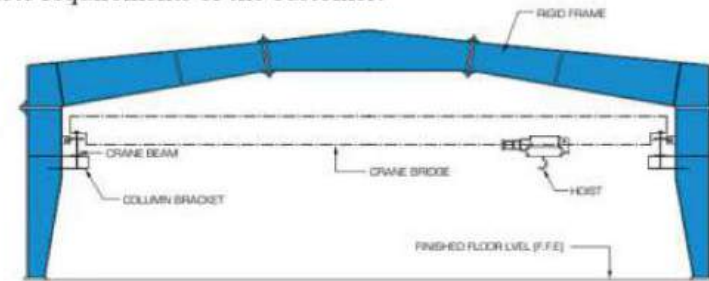

OVER HEAD CRANE

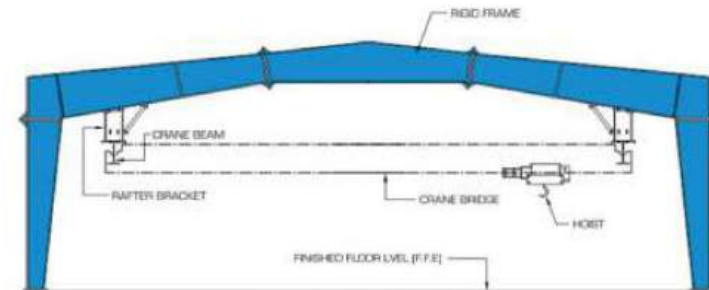

UNDERHUNG CRANE

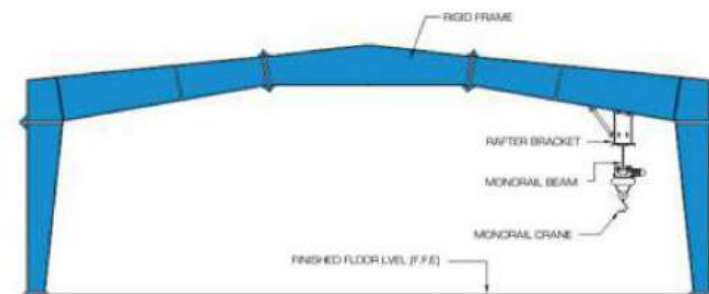

MONORAIL CRANE

Standing Seam Sheets

Ritutech offers innovative and technologically advanced concealed fixed and zipped-up standing seam system that creates a continuous weather tight roof. Ritutech (Standing Seam Sheets) is offering outstanding design potentiality; performance and durability making our Standing Seam Roofs look great aesthetically along with offering security and weatherproofing solutions. Due to concealed fitting the risk of leakage is reduced. Our sheets are manufactured using supreme quality material paired with contemporary techniques following the industry norms making us one of the most trusted Standing Seam Sheets manufacturers in India. When installed correctly a typical Standing Seam Metal Roofs will last anywhere from 20 to 30 years. Due to our product's advanced features, we are counted amongst reckoned names in the industry, committed towards offering a wide spectrum of Standing Seam Roof Sheets. We provide personalization of sheets according to the client's requirements furthermore, Ritu Tech Standing seam roof sheets are available at the most affordable rates making them one of the best Standing Roof Sheets exporters in India.

Ritutech offers outstanding design potential, performance and durability. Ritutech standing seam sheet can be offered in various profile width ranging from 300 mm to 500 mm. The standard profile width is 430 mm. Ritutech standing seam sheets can also be offered in tapered or curved profile and it can be site roll formed.

Ritutech standing seam sheet is advance in quality, provide wide cover range and strong concealed fix. It gives you a robust roofing system and are ideal for long span life in industrial, commercial and retail buildings.

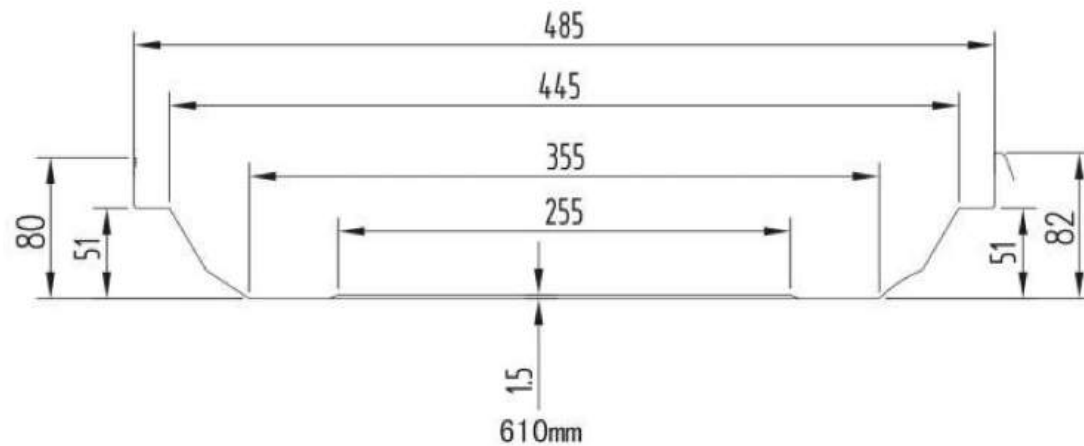

Ritutech Standing Seam Sheets

Ritutech standing seam sheeting solution is advanced, provide wide cover, concealed fix. This is a part of robust roofing system. This is ideal for long span life in industrial, commercial and retail buildings. The 180 degree and 360 degree option of seaming, not only makes it weather tight, but also is a perfect roofing system for high wind prone areas. Ritutech standing seam sheet can also be site roll formed.

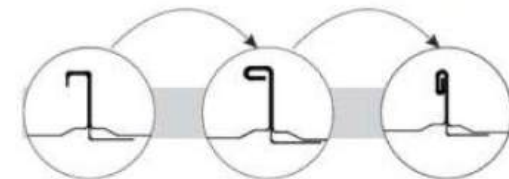

Multi Stories

MEZZANINE & DECKING SHEETS



Mezzanine Building Use : Commercial, Office, Industrial, Residential

It can be designed for various loads starting from 250 Kg / Sqm. upto 2000 Kg / Sqm. covering all offices & heavy structures.

We can provide pre-engineered building from one floor to multi level Mezzanine floors. Mezzanine can be opted with deck sheeting or checkered plates.

The floor is constituted by deck sheet onto which layer of concrete is poured. The Sheet is bonded to the concrete by means of moldings on the sheet which stop the concrete from slipping horizontally and detaching vertically.

Stage 1 : When the concrete is poured and until it has reached an appropriate level of hardening, the weight of the concrete, personnel working and equipment used are borne by the sheet alone.

Stage 2 : Once the concrete has hardened, the sheet and the concrete form a unified bond with all the characteristics of traditional reinforced concrete, where the sheet after having performed the function of frame work, acts as a metal reinforcement. Appropriate crop ends must be provided to absorb the negative emotions.

Advantages

- Tensile steel & composite slab construction that cuts down on slab thickness and dead weight of buildings.
- No separate frame work required for slab casting
- Reduces construction time.

Applications

- High rise buildings
- Multiplexes / Commercial buildings
- Power plant buildings
- Office buildings
- Mezzanine, floors in industrial buildings & warehouses
- Steel dock for Mezzanine floors

Heavy Structure Fabrications

It is our constant endeavour to upgrade our expertise and provide state of the art infrastructure to clients. Ritutech has earned a reputation for its engineering and construction excellence by providing multi-disciplinary, innovative and cost-effective solutions to critical projects. Backed by years of excellent construction activity with a large fleet of modern construction equipment and motivated pool of manpower with proven procedures and work systems and unique databases, Ritutech is committed to provide quality construction solutions to its clients. It has been an exciting journey with several challenges, new milestones reached, many more peaks to conquer.

Ritu Tech has over decades of rich experience in executing turnkey projects across diverse fields

Features :

- Tunnels
- Public health Engineering
- Ports
- Hydel Power
- Mining
- Commercial Building
- Transportation
- Oil & Gas
- Dams & Barrages
- Lift Irrigation
- Canals & Aqueducts
- Thermal Power Plants
- Industrial Structures
- Power Transmission



Projects



Projects

G+2



G+6



Projects



Projects



Projects



Projects

List of Few Projects

Baba Ramdev
NTPC
Dayal Fertilizers
BSF (National Building Construction Company)
SLMG Beverages Pvt. Ltd. (A Division of Coca Cola)
Indian Institute of Technology Roorkee (IITR)
SP Warehousing
Delhi Metro Rail Corporation
Maruti Suzuki
Shanti Kamj
Patanjali Ayurveda Ltd.
IMC (Rishiveda Herbal Company)
Dabur India Ltd.
Dainik Jagran
Saryam Auto Components
Lobha Star Linger Ltd.
Akmus Drugs & Pharmaceutical Ltd.
Hindustan Unilever Limited
VLCC Personal Care Ltd.
Kajima India Pvt Ltd. (A Japanese Group)
Hitech Logistics
Stonemen And Crafts
Mandi Samiti
Vashudha & Company
Bharat Industrial Corporation
ISGEC Heavy Engineering Ltd.
Saint Gobain (Unique Carrier)
Romsons
Tata Salt Warehouse
Crazy Bakery Udyog
Nova Ghee
Petkus India Pvt Ltd. (A German Company)
Konark Poly Tube
Godrej & Boyce Mfg. Co. Ltd.
Liberty Foams Pvt. Ltd.
Panasonic Jhajar
Roosen Industries (A German Company)
Crystal World (Himalaya Eco Park)
Kangra Logistics
Khattri Edibles Pvt. Ltd.
Mineral Oil Corporation
V.K. Tyre
RGPG Developers
Cawnpore Club
Autonix
Madhesh Namkeen
Shakumbhari Auto Wheel Pvt Ltd.
Saloni Edible Oil
S R Enagg. (Amul Warehouse)
Achal Amit & Company

Location

Alwar, Rajasthan
Narsinghpur, MP
Muzaffarpur, Bihar
Deiwala, Dehradun
Lucknow
Roorkee, UK
Shambhu, Punjab
Delhi
Gurgaon, Manesar
Haridwar
Haridwar
Haridwar
Baddi & Rudrapur
Jhansi
Haridwar
Kanpur
Haridwar
Orai, UP
Haridwar
Haridwar
Shambhu, Punjab
Agra
Rudrapur, UK
Rajpura, Punjab
Rewari, Haryana
Gadarwara, MP
Ludhiana
Agra, Noida
Kanpur
Gorakhpur
Kasganj, UP
Karnal, Haryana
Aligarh
Haridwar
Agra
Haryana
Unnao, UP
Haridwar
Rajpura, Punjab
Gorakhpur
Kanpur
Modinagar, UP
Agra
Kanpur
Noida
Lucknow
Roorkee/Bijnor
Kota, Rajasthan
Ghaziabad
Agra

List of Few Projects

RGL Ecopack
Royal Polymer
Navesons Paper Mill
Advance Panels & Switchgears Ltd.
Garima Milk Food Products
Ma Durga Rice Mill
Tata CNS Motors
ABR Perzo Chemicals
Bharat Marble
Youngman
Intas Pharmaceuticals Ltd.
Patial Builders
Atma Ram
Timurti Doors & Plywood Industries
Valencia Apparels
Shilpa Masale
Vinod Tripathi (V S Warehouse Service)
Madhu Agarwal Warehouse
Kala Bhawan
R.K Overseas
Nexa (Shakumbhari Auto)
Javi Homes
Hyundai GP Motors
Roger Export
Focus Energy
Ashoka Leyland Sumner Sons
Kandhenu Cattle Feed
HELLA India Lighting Ltd.
S.K Glass
OOM Export
Honda (Admirer Honda)
Prayagi Chemicals
Adler Wood India Pvt. Ltd.
Alumika Packaging
Saraswati Agrotech
Khandelwal Company
Durga Manufacturing Company
Tatal Industries
Sharma Stone
Narayan Seeds
Munjil Footwear
Manchanda
Toyal Traders
Vianca Industries
Bestek
Puerto Life Science Pvt. Ltd.
Hilltop Traders
Dewan Packaging
New Malik Transport
Vee Tee Auto Manufacturing Pvt. Ltd.

Location

Gurugram
Agra
Dholpur, Rajasthan
Haridwar
Dholpur, Rajasthan
Gorakhpur
Bijnor, UP
Gorakhpur
Delhi
Una, Himachal Pradesh
Dehradun
Ludhiana
Mathura
Yamunanagar, Haryana
Ranchi
Agra
Kanpur
Allahabad
Moradabad
Alwar
Roorkee
Panipat, Haryana
Allahabad
Agra
Jaunpur, Rajasthan
Agra
Kanpur
Dera Bassi, Punjab
Ghaziabad
Agra
Dehradun
Ranchi, Jharkhand
Ambala, Haryana
Dholpur, Rajasthan
Lucknow
Mathura
Kanpur
Alwar
Agra
Aligarh
Agra
Agra
Ghaziabad
Alwar
Ghaziabad
Alwar
Barabanki, UP
Gorakhpur
Kushinagar, UP
Bhadradab, UK

List of Few Projects

Balaji Tools
Universal Warehouse
Vedanta Enterprises
Agarwal Polyplast
Amlesh Enterprises
IILM University
Gupta Continental Pvt. Ltd.
Eco Green
Amul Warehouse
Trella Footwear
MM Sales
Super Tenary
Sirohi Chemtech
Sewa Surgicals
Riddhi Siddhi Logistics
Amit Export
SR International
SN Chemicals
JSW Enterprises
SR Engineering
Shakti Polypipes
Enkay Export
BM Steel
Ganpati Steel
Adarsh Marketing
Kishore Export
Amit Packaging
Amren Boards
Sanghavi Shoes
Scorpion Club
G.P Motors
Honda (Vibrant Honda)
Dellii Public School
Radhe Krishna Enterprises
Sanjay Packaging
Force Motors
KD Motors
Basant Oil
Sanarpan Pathology
Pragati Chemicals
Dawar Shoes
Nitra College
Onkar Furniture
Balaji Trading Company
Sardar Motor
Big Basket
TM Overseas
RGPG Real Estate
Modern Steel Ltd.

Location

Aligarh
Kanpur
Gorakhpur
Mathura
Mathura
Gurugram
Agra
MP
Gorakhpur
Agra
Agra
Kanpur
Ghaziabad
Gorakhpur
Kanpur
Agra
Kanpur
Kanpur
Aligarh
Ghaziabad
Agra
Agra
Dholpur, Rajasthan
Ghaziabad
Ghaziabad
Ranchi
Hamirpur, UP
Barabanki, UP
Agra
Lucknow
Allahabad
Aligarh
Moradabad
Alwar
Gorakhpur
Aligarh
Saharanpur, UP
Mathura
Agra
Ranchi
Agra
Ghaziabad
Gorakhpur
Alwar
Sant Kabir Nagar, UP
Noida
Agra
Jodhpur, Rajasthan
Mandi, Himachal Pradesh



Office :

Suite No. - 03,
H-140, BSI Business Park,
H Block, Sector - 63,
Noida (U.P.) 201307

Mobile : 09540483838
Email : ankit@ritutech.net

Work :

Plot No. - 51 to 56, Sector - 5,
IIE, Sidcul, Haridwar - 249403 (U.K.)

Mobile : +91-8194001390
Email : sales@ritutech.net

Branch Office :

Plot No. - 201A, 2nd Floor (Padam Business
Park), Sector-12A, Avas Sikandara Yojana,
Agra (U.P.) 282007

Mobile : +91-9927406826
Email : sumant@ritutech.net



Toll Free
1800 274 2828

For more information : www.ritutech.net